



TC UV 12 64

UV Bi-Telecentric Lens for detectors up to 1/2"



part number	TC UV 12 64	
Range	(nm)	365 / 420
Magnification		0,100 +/- 3%
Object Field	(mm x mm)	
with 1/4" (3,6 x 2,7) detector		36,0 x 27,0
with 1/3" (4,8 x 3,6) detector		48,0 x 36,0
with 1/2" (6,4 x 4,8) detector		64,0 x 48,0
with 1/1.8" (7,13 x 5,37) detector		71,3 x 53,7
with 2/3" (8,8 x 6,6) detector		diam. = 66,0
Working Distance	(mm)	176,0 +/- 5
Working F-number		8
Telecentricity	(degree)	< 0,08
Distortion	(%)	< 0,08
Field Depth	(mm)	66,0
CTF @70 lp/mm	(%)	> 40
Image side N.A.		0,0620
Object side N.A.		0,0062
Mount		C
Length	(mm)	219,7
External diameter	(mm)	100,0
Weight	(g)	1100

Possible vignetting at the image corners with 1/1.8" detectors

Rev No.	Description	Date	Name
A	First light	09/05/08	A.Vismara

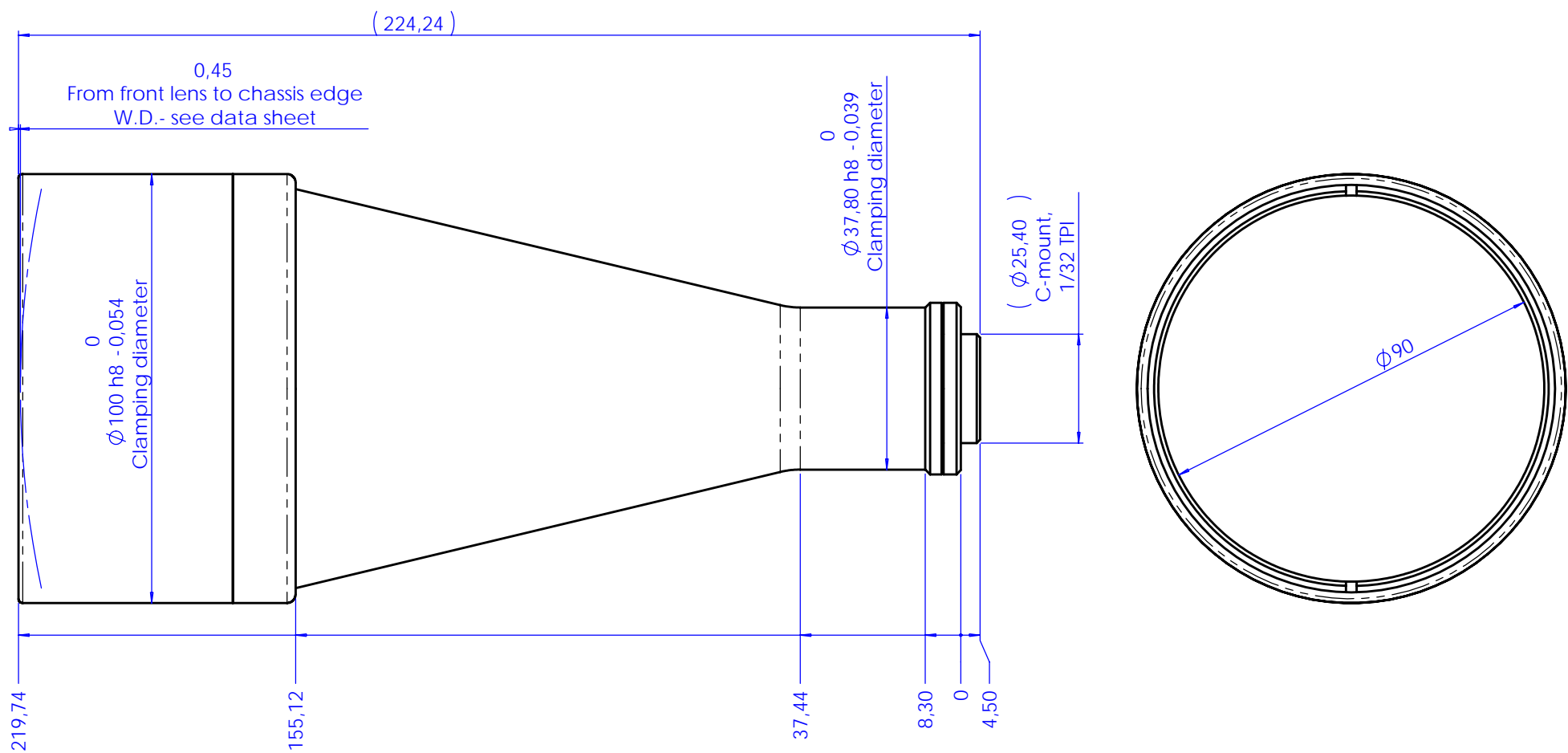

Material	N.A.			Mass	1.1 kg	Scale	1:1
Surface treatment	N.A.			Project-Prod.Item/Instrument Telecentric lens UV 12 64			
Geometrical tolerance (ISO 2768-2)			Class	K	Description		
Linear tolerance (ISO 2768-2)			Class	m	Undimensioned bevels	1x45°	Assembly
0.5	>3-	>6-	>30-	>120	>400-	>1000	
+3	6	30	120	+400	1000	+2000	±2
±0.1	±0.1	±0.2	±0.3	±0.5	±0.8	±1.2	±2
			Date	Name	Drawing No.		
www.opto-engineering.com			Designed	09/05/08	A.Vismara	02629-0-A	
			Draw	09/05/08	A.Vismara	Sheet	
			Checked	X	C. Sedazzari	1/1	
Reproduction forbidden without specific authorization							

